



# LIGHTING SQUARED



BOX 20 C

## BOX 20 C SERIES

A minimal geometric form designed to accent the current modern design. An electrostatically applied powdercoat for a durable finish. Special colors are available upon request for additional appearances. .

The BOX 20 Series is an energy efficient design capable of using both LED or more traditional light sources. This family of luminaires has companion wall and pendant versions available.

BOX 20 C mounts to 3.5" octagon box/ceiling box for ease of installation.

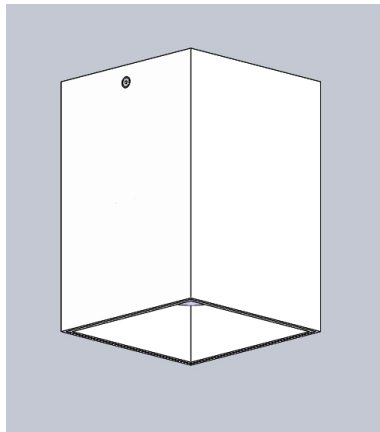
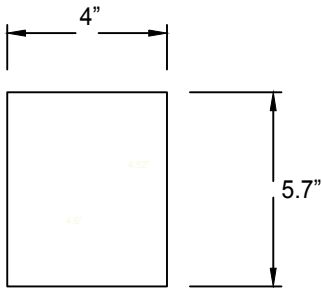

### DESIGN OPTIONS

MODEL	FINISH	MOUNTING	VOLTAGE		LIGHT SOURCE
BOX 20 C	COLOR	CEILING - INTERIOR	120		1 X PAR20/PAR30 35 WATT MAXIMUM

